

Chen Zhang

Apply for Landscape Architect

Contact | mgchen@umich.edu
(734)272-2686

EDUCATION

- Master of Landscape Architecture, Landscape Architecture (GPA: 3.78/4.0) September 2015 - April 2018
University of Michigan School for Environment and Sustainability Ann Arbor, MI, USA
- Bachelor of Engineering, Landscape Architecture (GPA: 3.50/4.0) September 2011 - June 2015
Nanjing Forestry University College of Landscape Architecture Nanjing, Jiangsu, CHN

EXPERIENCE

- Walker Macy Seattle, WA
Externship February 2018 - March 2018 Mentor: Ann Marie Schneider
• Help with playground studies and general stormwater strategies for non-infiltrating sites; Stormwater graphics for waterfront park
• Project: Edmonds Civic Center Playfield, Bainbridge Waterfront Park in Washington State
- W&R Landscape Design Co., Ltd Shanghai, CHN
Intern Landscape Architect June 2017 - July 2017 Mentor: Li Yang
• Applied "circle" concept and enclosed space inspired from Chinese traditional residence courtyard into landscape design, creating a safe, educational and playful kindergarten outdoor landscape including a gradually changing space from totally open to semi-open to private
• Project: Kindergarten Landscape Design for Qingdao Zhonglian Residential Area in Shandong Province and various residential projects
- Urban Construction & Design Research Institute Shanghai, CHN
Assistant Landscape Architect January 2014 - February 2014 Mentor: Lin Liu
• Focused on the harmony of existing historical river and prosperous urban life, creating an ecologically continuous greenbelt along some old roads in Shanghai
• Project: Shanghai Yongding River and No. 4 road greenbelt landscape design, Qibao Culture Square design renovation

ACTIVITIES

- Detroit River International Wildlife Refuge New Area Master Plan and Public Access Study Detroit, MI
March 2017 - April 2018 Advisor: Robert Grese
• Use multiple tools and strategies such as GIS-based method to conduct ecological analysis of the site, developing the site in terms of wildlife conservation and public access that inspire visitors and foster appreciation in the local natural landscape
- Sustainable & Resilient 2040 Future for Northwest Detroit Neighborhoods Detroit, MI
November 2017 - February 2018 Advisor: Joan Iverson Nassauer
• Reconfigured the neighborhood landscape and infrastructure pattern to more efficiently deliver city services and enhance quality of life in the neighborhood and surrounding area, considering global changes as well as local cultural, social, housing and environmental legacies and characteristics
- EPA Campus RainWorks Challenge Competition Ann Arbor, MI
September 2016 - November 2016 Advisor: Stanton Jones
• Created a "Stormwater Walkway" on campus, solving the stormwater problems the campus center is facing; proposed a feasible and aesthetic plan to enhance the historical and cultural meaning of the University of Michigan such as small rain garden at lawn edge and metal sculptures based on campus development
- Yuanye Cup Landscape Architecture International Competition Shanghai, CHN
February 2015 - June 2015 Advisor: Bing Qiu
• Modified the broken landscape between office buildings in CBD and waterfront space by creating diverse spatial characters to provide places for different activities and continuous pedestrian circulation and place for people to stay; form inspired from wave, alluvial fan and voronoi

MY SPECIALITIES

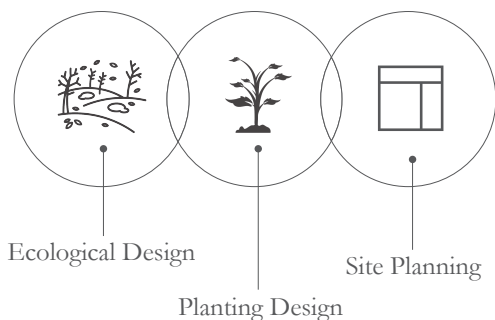

DESIGN SKILLS

01 Computer

- Adobe Photoshop ●●●●●●●●
- Adobe Illustrator ●●●●●●●●
- Adobe Indesign ●●●●●●●●
- ArcGIS ●●●●●●●●
- AutoCad ●●●●●●●●
- SketchUp ●●●●●●●●
- Lumion ●●●●●●●●
- Microsoft Office ●●●●●●●●

02 Knowledge

- Construction Document
- Ecology Concept & Applications
- Graphic Design
- Landscape Planning
- Principle of GIS
- Site Engineering
- Urban Agriculture
- Woody Plants

LANGUAGE

