

Practice Problem – Section C

PROBLEM STATEMENT:

Prepare two alternatives for a proposed townhouse development with site amenities.

REQUIRED:

Prepare two site plans based on two significantly different concepts. Both solutions must accomplish the following:

- Show and label all project elements using the graphic symbols shown to the right. Maintain the size and shape provided for each project element EXCEPT for the open space which may be drawn in any shape at the approximate size shown. NO project elements may be subdivided.

Townhouse Cluster - A total of six (6) clusters are required with a minimum 30' [9m] separation between clusters.

Pool Complex Pool complex to be located for easy access from each townhouse cluster.

Open Space Turf area for picnics and gatherings.

- Indicate 20 parking spaces for the pool on the site. Indicate parking by using the graphic convention provided.

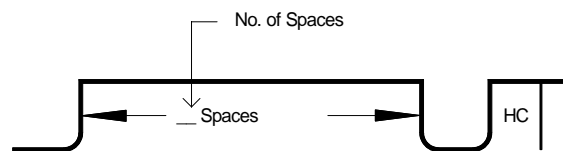

Not to Scale

- Provide a detailed vehicular circulation route to the parking for the pool and to each townhouse cluster.
- Indicate the direction of vehicular circulation with arrows.
- Provide a pedestrian connection from each townhouse cluster to the pool complex without crossing any vehicular circulation using the graphic provided.

PROJECT ELEMENTS

Scale: 1" = 100' [1:1000]

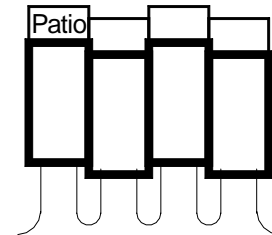

Townhouse Cluster
(6 - required)

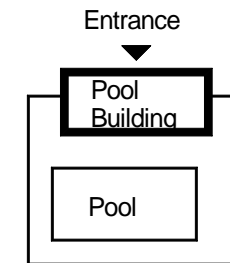
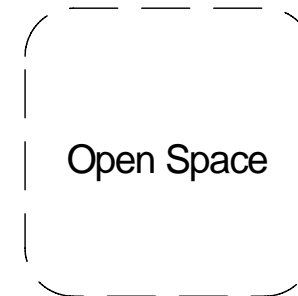

Pool Complex

C-2

March 2009

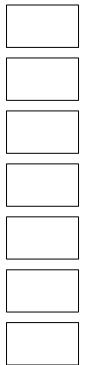

Candidate I.D.

Landscape Architect Registration Examination

Site Design

Council of
Landscape
Architectural
Registration
Boards

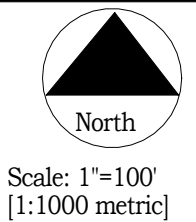
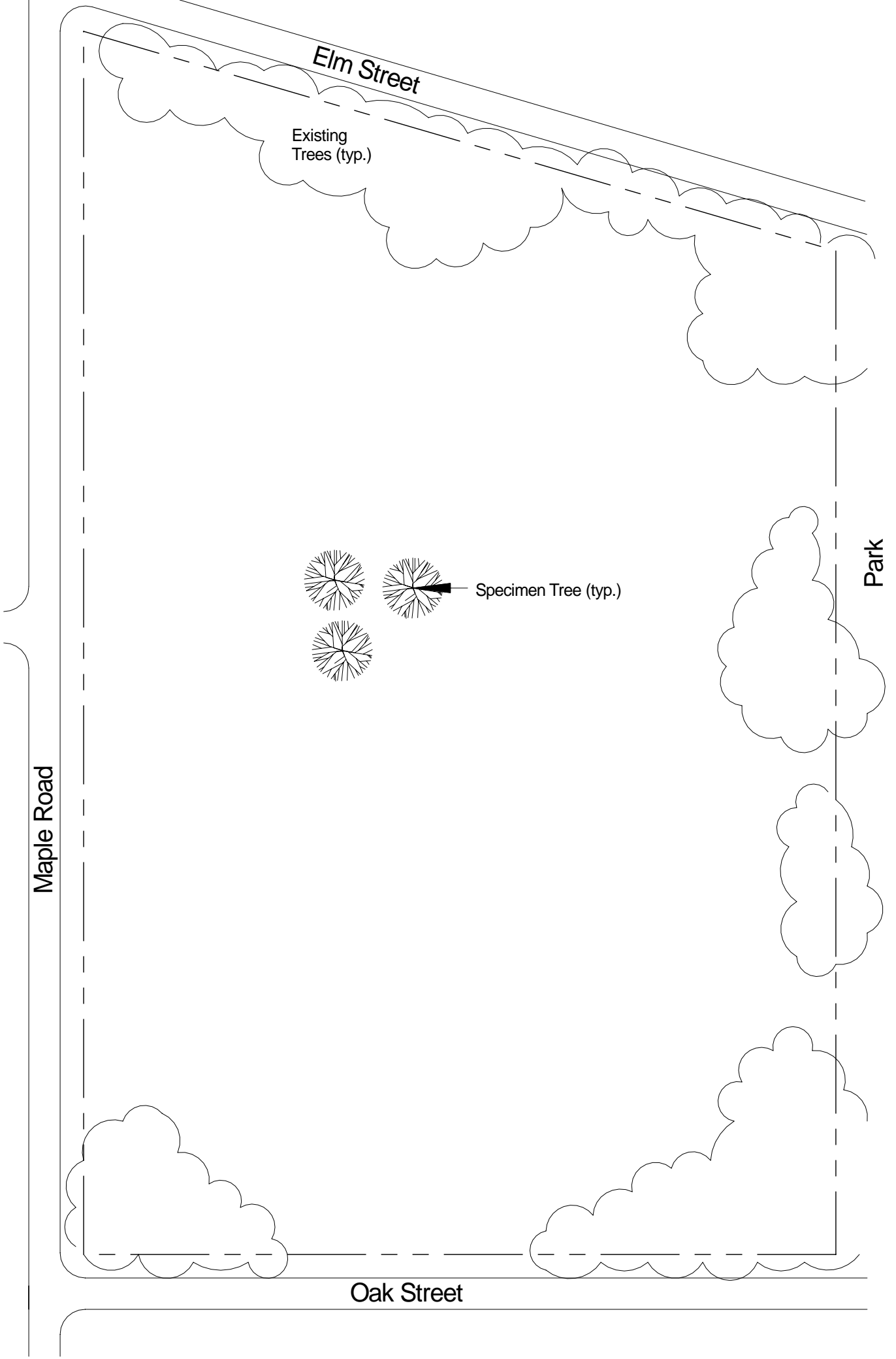
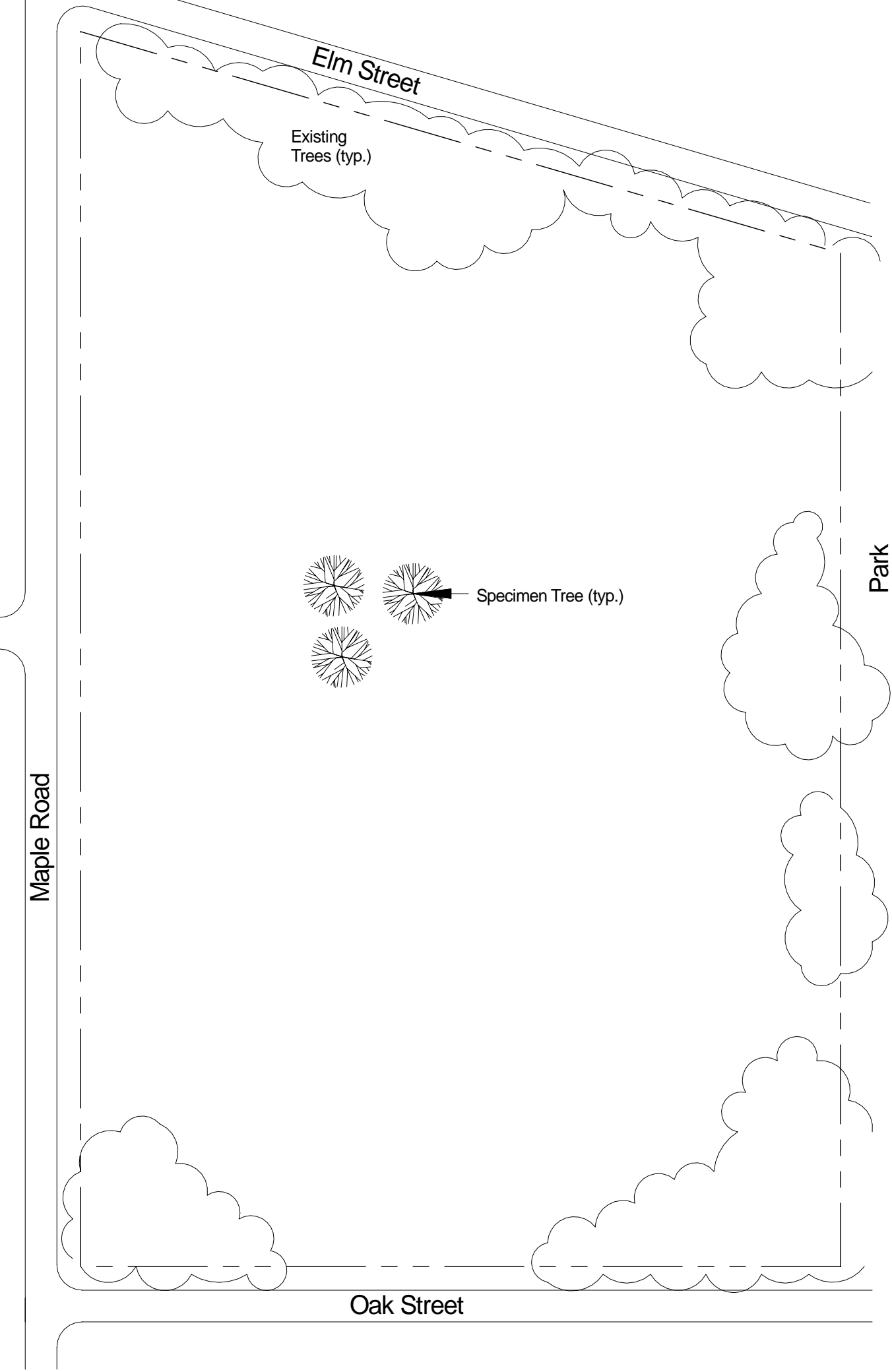

Scale: 1"=100'
[1:1000 metric]

Council of
Landscape
Architectural
Registration
Boards

Landscape Architect Registration Examination

Site Design

<input type="checkbox"/>	<input type="checkbox"/>
<input type="checkbox"/>	<input type="checkbox"/>
<input type="checkbox"/>	<input type="checkbox"/>
<input type="checkbox"/>	<input type="checkbox"/>
<input type="checkbox"/>	<input type="checkbox"/>
<input type="checkbox"/>	<input type="checkbox"/>

Candidate I.D.

C-2

March 2009